

HO1 - HIGH OUTPUT 1 LAMP

General

High Output strips are used in cold weather applications where starting temperatures could be as low as -20°F/-29°C.

Ideal for garages, workshops, and other commercial applications.

Suitable for surface, pendant, and continuous row mounting.

Housing & Finishing

Die-formed cold rolled steel finished in pre-painted high-gloss white. Shallow body due to new electronic ballasts.

Optional wire guard protects the fixtures from impact and breakage.

Electrical

Available in electronic ballasts only.

Available voltages: 120V/277V/347V and UNV.

Approval

CSA and UL certified.

Project			
Catalog #			
Volts		Lamp(s)	
Ballast Type			
Type		Date	
Approved by			

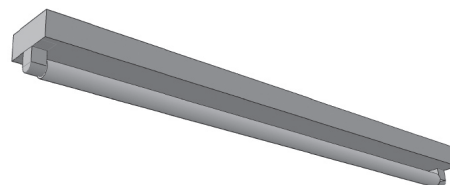

Ordering Information

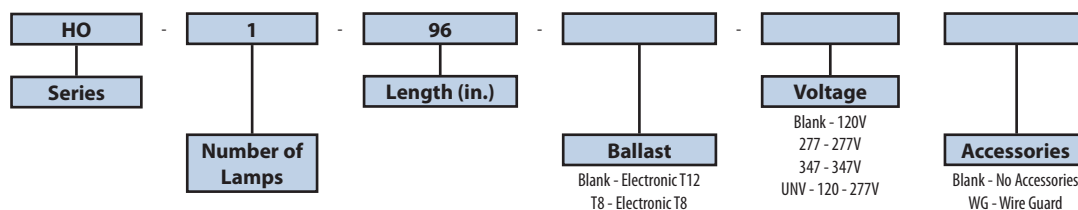

Product Availability

Item	Dimensions (L x W x D)	Lamps/ Cross Section	Lamps/ Fixture	Lamp Watt T12	T8
HO 148	48" x 4 1/2" x 2"	1	1	60	44
HO 196	96" x 4 1/2" x 2"	1	1	110	86
HO 196T	96" x 4 1/2" x 2"	1	2	60	44

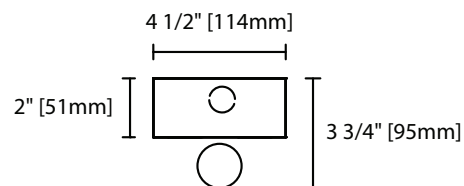

HO1 Cross Section View

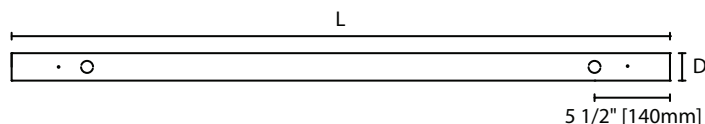

HO1 Side View

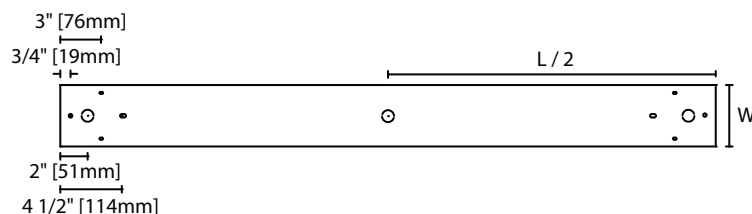

HO1 Base View