

ST2-SG - STRIP STAGGERED 2 LAMPS

General

Staggered low profile strip for applications requiring elimination of shadow effects caused by sockets in continuous row mountings.

Ideal for cove and under-cabinet lighting.

Housing & Finishing

A low profile body made of die-formed cold rolled steel finished in pre-painted high-gloss white.

Electrical

Available in electronic ballasts only.

Available voltages: 120V/277V/347V and UNV.

Approval

CSA and UL certified.

Project	
Catalog #	
Volts	Lamp(s)
Ballast Type	
Type	Date
Approved by	

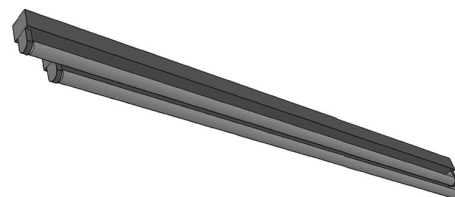

Ordering Information

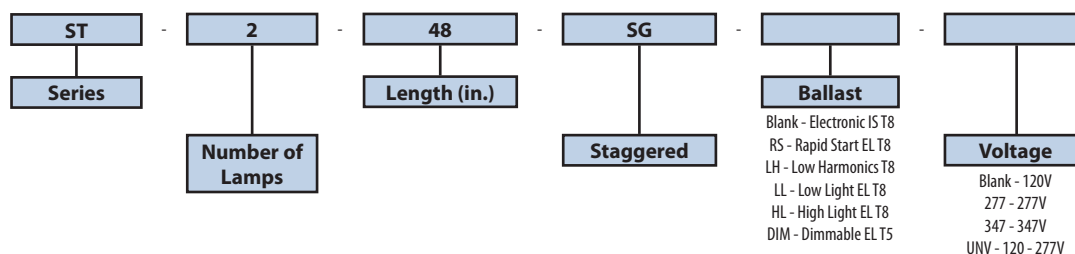

Product Availability

Item	Dimensions (L x W x D)	Lamps/ Cross Section	Lamps/ Fixture	Lamp Watt T8
ST 224-SG	27" x 3 1/4" x 1 1/2"	2	2	17
ST 236-SG	39" x 3 1/4" x 1 1/2"	2	2	25
ST 248-SG	51" x 3 1/4" x 1 1/2"	2	2	32
ST 236/2-SG	75" x 3 1/4" x 1 1/2"	2	4	25
ST 248/2-SG	99" x 3 1/4" x 1 1/2"	2	4	32

