

# HO1 R - INDUSTRIAL HIGH OUTPUT 1 LAMP

## General

High Output industrial strips are used in cold weather applications where starting temperatures could be as low as -20°F/-29°C.

Ideal for garages, workshops, and other commercial applications.

Suitable for surface, pendant, and continuous row mounting.

## Options

Asymmetrical reflectors.

Specular reflectors of high-gloss polished metal.

Slotted reflectors provide 10% up-light.

Wire guards protect the fixtures from impact and breakage.

## Housing & Finishing

Die-formed cold rolled steel finished in pre-painted high-gloss white. Shallow body due to new electronic ballasts.

## Electrical

Available only in electronic ballasts.

Available voltages: 120V/277V/347V and UNV.

## Approval

CSA and UL certified.

<b>Project</b>	
<b>Catalog #</b>	
<b>Volts</b>	<b>Lamp(s)</b>
<b>Ballast Type</b>	
<b>Type</b>	<b>Date</b>
<b>Approved by</b>	

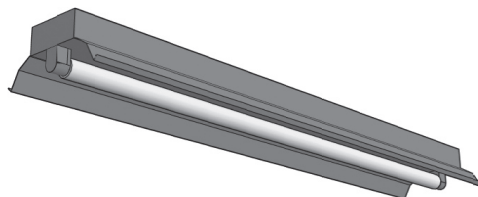

## Ordering Information

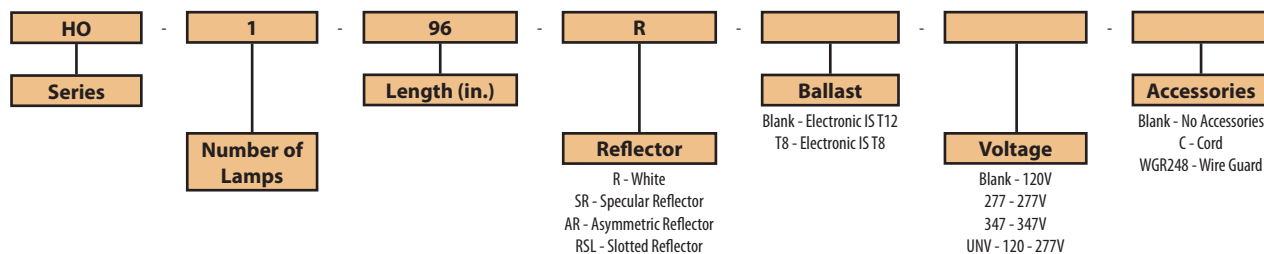

## Product Availability

Item	Dimensions (L x W x D)	Lamps/ Cross Section	Lamps/ Fixture	Lamp Watt T12	T8
HO 148-R	48" x 9" x 4"	1	1	60	44
HO 196-R	96" x 9" x 4"	1	1	110	86

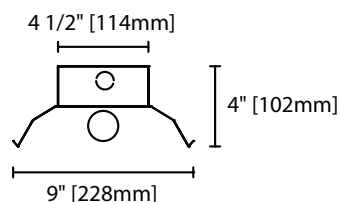

HO1 R Cross Section View

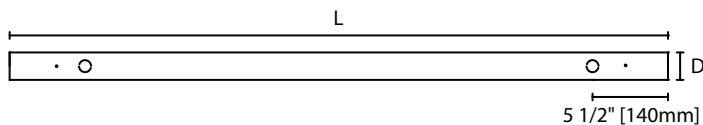

HO1 R Side View

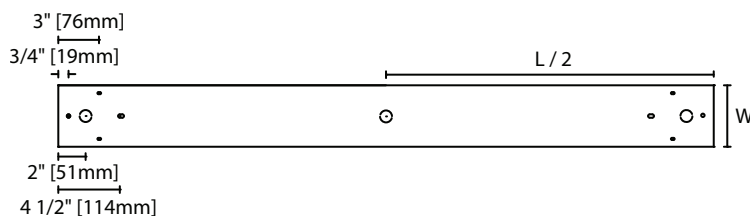

HO1 R Base View