

ST3 R - INDUSTRIAL STRIP 3 LAMPS

Project		
Catalog #		
Volts		Lamp(s)
Ballast Type		
Type		Date
Approved by		

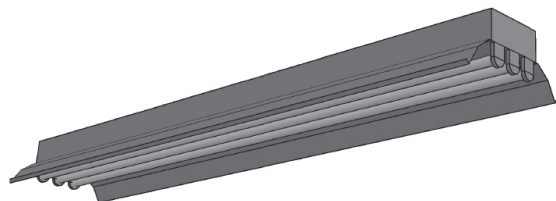

General

Highly efficient commercial or industrial fixture ideal for general lighting applications.

Suitable for surface and continuous row mounting, with easy snap-out endplates which are used as joiner plates.

Reflector provides a wide distribution of light with a shielding angle of 15° below horizontal.

Housing & Finishing

Die-formed cold rolled steel finished in pre-painted baked high-gloss white polyester finish.

Options

Asymmetrical reflectors.

Specular reflectors of high-gloss polished metal.

Slotted reflectors provide 10% up-light.

Wire guards protect the fixtures from impact and breakage.

Electrical

Available only in electronic ballasts.

Available voltages: 120V/277V/347V and UNV.

Approval

CSA and UL certified.

Ordering Information

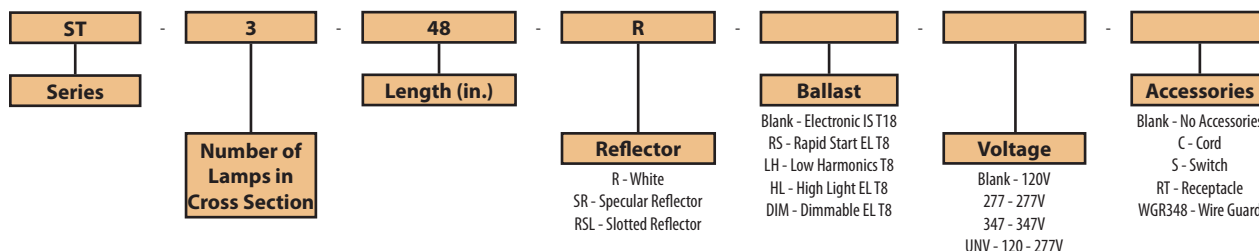

Product Availability

Item	Dimensions (L x W x D)	Lamps/ Cross Section	Lamps/ Fixture	Lamp Watt T8
ST 348-R	48" x 9" x 4"	3	3	32
ST 396T-R	96" x 9" x 4"	3	6	32

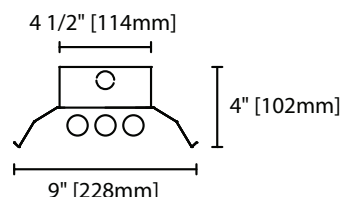

ST3 R Cross Section View

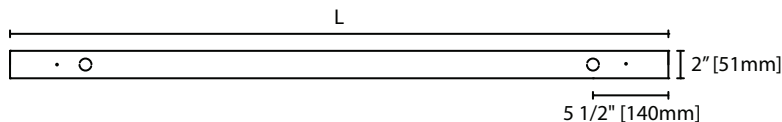

ST3 R Side View

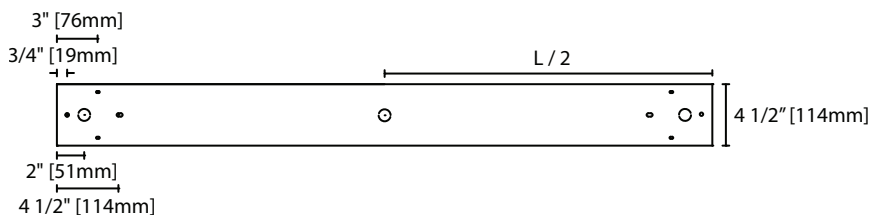

ST3 R Base View