

TB M - T-BAR METRIC

General

High performance lensed troffer for grid ceiling installations. Hinged door with rotary cam latches and only 100mm depth for shallow plenums.

This is fixture is for metric grid.

Housing & Finishing

Die-formed pre-painted cold rolled steel finished in high-gloss white.

Lens & Louvers

Prismatic acrylic K-12 pattern is standard. Lens is in framed door with cam latches and hinges

Other prismatic patterns, lenses and louvers are available upon request.

Reflectors

Specular reflectors to increase light and reduce lamps are available on request.

Electrical

Standard easy access wiring plate .

Available in electronic ballasts only.

Available voltages: 120V/277V/347V and UNV.

Approval

CSA certified.

Project		
Catalog #		
Volts		Lamp(s)
Ballast Type		
Type		Date
Approved by		

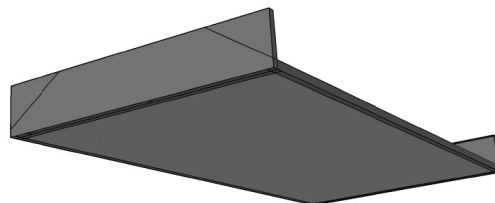

Ordering Information

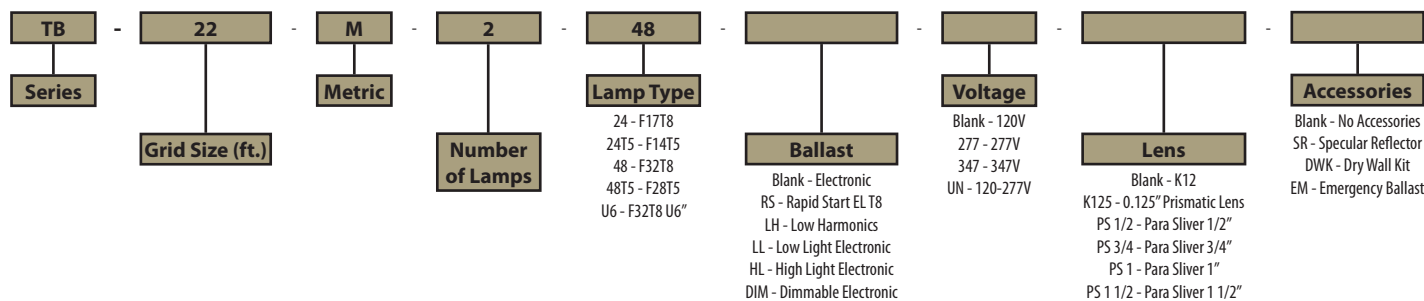

Product Availability

Item	Dimensions (L x W x D)	Lamps/ Cross Section	Lamps/ Fixture	Lamp Watt	
				T8	T5
TB 22M-2U6	600mm x 600mm x 100mm	2	2	32	
TB 22M-424	600mm x 600mm x 100mm	4	4	17	14
TB 24M-248	1200mm x 600mm x 100mm	2	2	32	28
TB 24M-348	1200mm x 600mm x 100mm	3	3	32	28
TB 24M-448	1200mm x 600mm x 100mm	4	4	32	28

