

ST1 T5 - STRIP 1 LAMP T5

General

Surface mount fixture with a small body using the latest T-5 fluorescent technology.

Ideal for functional applications requiring ample lighting in tight spaces such as under-cabinet, display cabinets, and valance lighting.

Suitable for surface and continuous row mounting.

Housing & Finishing

Die-formed cold rolled steel finished in pre-painted high-gloss white.

Remote Ballast Configuration

Fixtures with remote ballast are available for lengths from 2' to 5'.

Electrical

Available in electronic ballasts only.

Available voltages: 120V/277V/347V and UNV.

Approval

CSA and UL certified.

Project	
Catalog #	
Volts	Lamp(s)
Ballast Type	
Type	Date
Approved by	

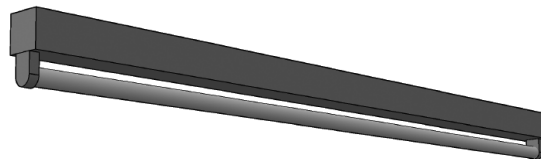

Ordering Information

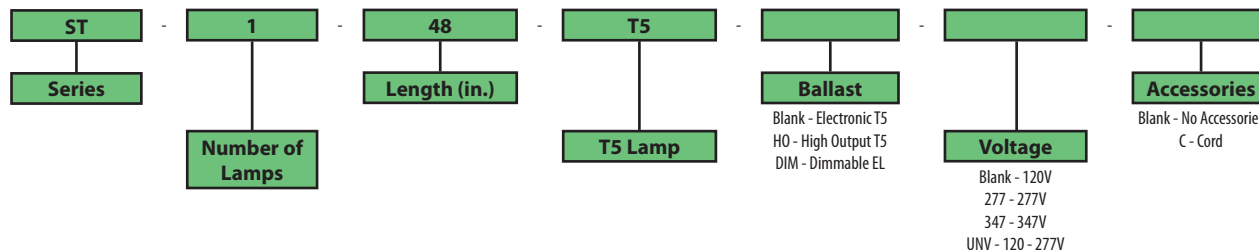

Product Availability

Item	Dimensions (L x W x D)	Lamps/ Cross Section	Lamps/ Fixture	Lamp Watt	
				T5	T5HO
ST 106-T5	6" x 1 3/8" x 1 1/2"	1	1	4	
ST 109-T5	9" x 1 3/8" x 1 1/2"	1	1	6	
ST 112-T5	12" x 1 3/8" x 1 1/2"	1	1	8	
ST 124-T5	22" x 1 3/8" x 1 1/2"	1	1	14	24
ST 136-T5	34" x 1 3/8" x 1 1/2"	1	1	21	39
ST 148-T5	46" x 1 3/8" x 1 1/2"	1	1	28	54
ST 160-T5	58" x 1 3/8" x 1 1/2"	1	1	35	80
ST 172T-T5	68" x 1 3/8" x 1 1/2"	1	2	21	39
ST 196T-T5	92" x 1 3/8" x 1 1/2"	1	2	28	54

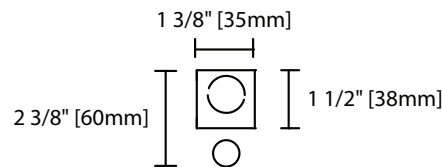

ST1 T5 Cross Section View

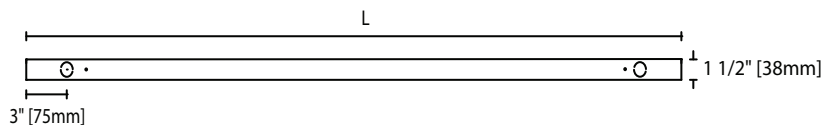

ST1 T5 Side View

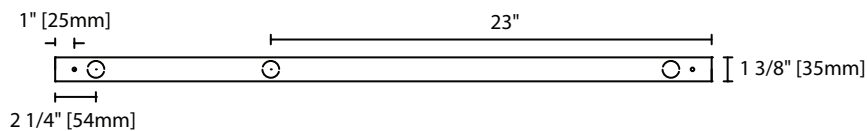

ST1 T5 Base View